

T-FLOOR

1/2

Separating and cover profiles for subsequent application

DURAL

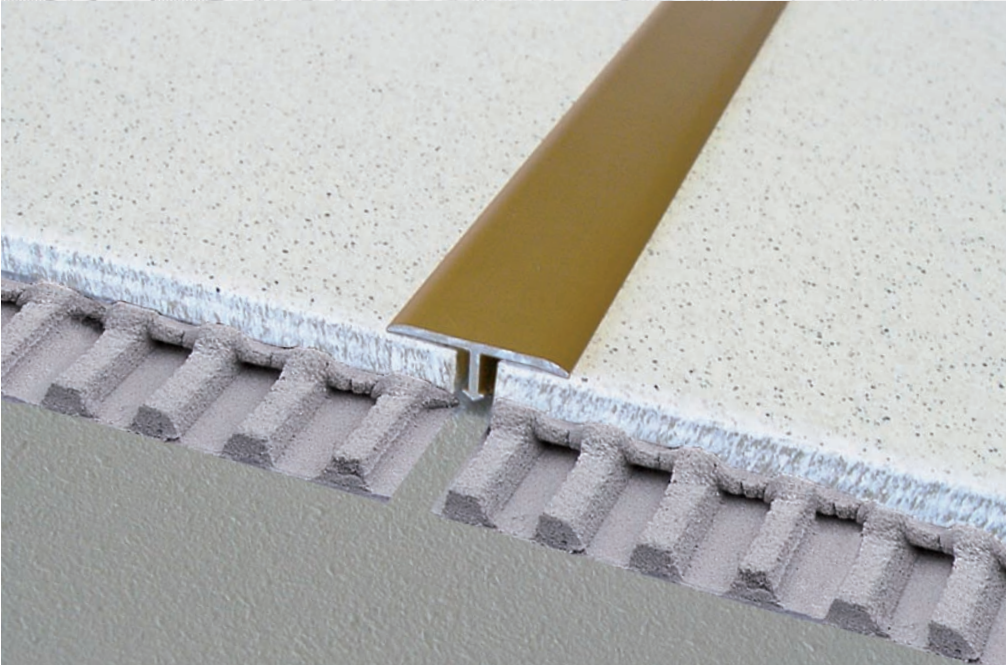

Aluminium, Brass

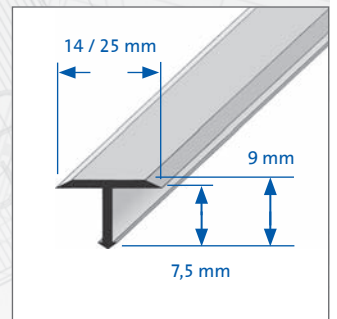
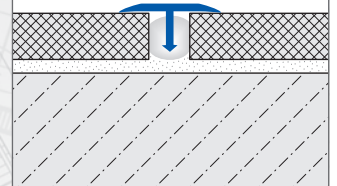

APPLICATION:

T-FLOOR Transition Strips by Dural are developed for linking adjacent flooring materials with no or little difference in height. The T-shape allows subsequent application. The use of special tools is not required. T-FLOOR Transition Strips are simply pressed into a joint filled with silicone. T-FLOOR links ceramics and parquet, natural stone, concrete, parquet or laminate. The respective edges are covered in such a way that the marginal areas of the flooring material cannot be damaged.

T-FLOOR Transition Strips (aluminium and brass) are also available in a flexible version "Z-Flex".

Stainless steel

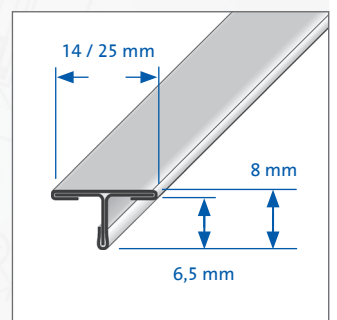
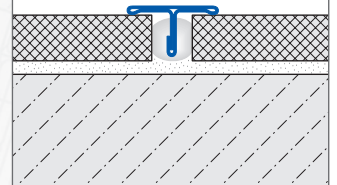

MATERIAL:

The following versions of T-FLOOR are available: aluminium natural; aluminium anodised; brass natural; brass high gloss finish („Star“ with peel-off strip); brass chrome-plated („Star“ without peel-off strip); stainless steel high gloss and polished („Star“ with peel-off strip).

EIGENSCHAFTEN:

T-FLOOR Transition Strips in **aluminium** are suitable where no exceptional chemical reactions are expected. Careful handling of cement materials is required to avoid corrosion. Because aluminium is sensitive to alkaline media's all residues of mortar, tile cement or joint cement have to be immediately removed from all visible surfaces. The profile is to be completely embedded into the contact layer. This avoids cavities to generate where alkaline water might accumulate.

T-FLOOR Transition Strips of **anodised aluminium** are of special refinement and therefore the surface is usually not subject to changes. The visible surfaces must be protected against any cement materials. Damages can occur because of scratching or abrasive objects.

DURAL GmbH & Co. KG

Südring 11

D-56412 Ruppach-Goldhausen

Tel. +49 (0) 2602/9261-0

Fax +49 (0) 2602/9261-50

welcome@dural.de

Separating and cover profiles for subsequent application

T-FLOOR Transition Strips of **brass** are appropriate for application in domestic areas and industrial buildings. They are resistant to major stresses and mostly resistant to chemicals generating during the laying of tiles. Important: brass oxidizes when exposed to air, especially with high humidity. The surface is covered with a patina (protective layer) and changes its appearance.

T-FLOOR Transition Strips of **stainless steel** are especially appropriate for areas subjected to high stresses because of chemicals and acids. Also the mechanical resistance is meeting highest requirements. Stainless steel profiles are used for example in the foodstuff industry, in hospitals, swimming-pools and breweries. The following is valid for all materials: The suitability of each profile with respect to mechanical and chemical resistance is to be examined for each individual case.

For all products and materials, the following applies: The suitability of the material with regard to the expected mechanical loading and chemical exposure must be investigated carefully in each individual case. The generally recognised rules of good engineering practice must always be observed!

HANDLING:

1. Clean the joint inside (at least a depth of 9 mm).
2. Fill the joint with single-pack silicone.
3. Press the T-FLOOR profile into the joint until it is completely in contact with the flooring materials.
4. Remove any surplus silicone from the edges using cleaning material.

CARE AND MAINTAINANCE:

T-FLOOR Transition Strips do not require any special care. Oxidation layers can be removed with polishing material. A permanent removal however is not possible. The cleaning materials must be free of hydrochloric acid and hydrofluoric acid and must not be abrasive.

PRODUCT DATA:

MATERIAL:	<ul style="list-style-type: none">- Aluminium natural- Aluminium anodised (silver, gold, titanium)- Brass natural- Brass high gloss polished („Star“ with peel-off strip)- Brass chrome plated („Star“ without peel-off strip)- Stainless steel natural- Stainless steel brushed (grain 240, Mat V2A), („Star“ with peel-off strip)- Stainless steel high gloss polished (Mat. V2A), („Star“ with peel-off strip)
LENGTH:	100 cm (Aluminium, Brass) / 250 cm (Aluminium, Brass, Stainless steel)
WIDTH:	14 / 25 mm
HEIGHT:	7,5 mm (Aluminium, Brass), 6,5 mm (Stainless steel)

DURAL GmbH & Co. KG

Südring 11

D-56412 Ruppach-Goldhausen

Tel. +49 (0) 2602/9261-0

Fax +49 (0) 2602/9261-50

welcome@dural.de